

GPI

Grand Prix Fuel Injector
Up to 1.5 MPa - Up to 2.2 L/min
Multihole technology

Description

GPI injector has been developed to meet the market requirements for a cost effective injector for high performance racing injection systems.

Incorporating Formula 1 technology, it is available in basic configuration or customized in spray shape and flow rate and will be selected in narrow precision classes.

Main Features

- Delivery pressure range 0.3 to 1.5 MPa
- Static flow range 0.15 to 2.2 L/min
- Spray pattern multihole
- Driver On/Off or Peak & Hold

Benefits

- Multihole spray shaping
- Custom spray configurations can be developed on request
- On/Off or Peak & Hold driven
- High precision
- Suitable for use with Methanol
- Small dimension & weight

Typical Applications

IRL

In circuit and rallies application

Race motorcycle application



Typical Performance

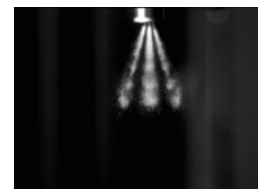
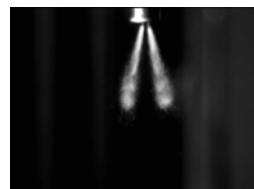
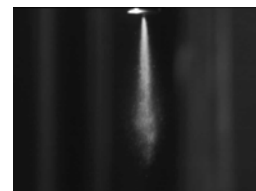
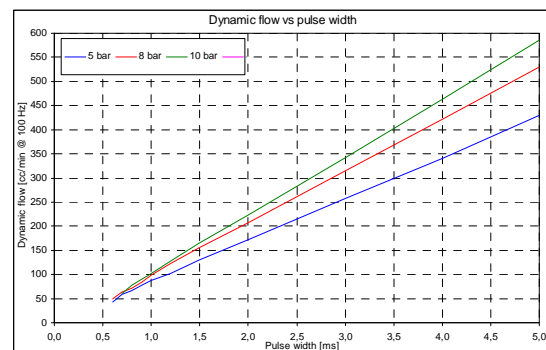

INJECTORS

GPI

Grand Prix Fuel Injector
Up to 1.5 MPa - Up to 2.2 L/min
Multihole technology

Technical Characteristics

Delivery pressure range	0.3 to 1.5	MPa
Static flow range.....	0.15 to 2.2	L/min
Driver current	< 3	A
Spray angle.....	up to 75°	
Power supply.....	8 to 16	V
Operating temperature range	-20 to 120	°C
Connector type.....	cable 2 x 0.3 mm ² /37	
Weight.....	38	g

Note: on request possibility to arrive up to 3 MPa

Application Schematics

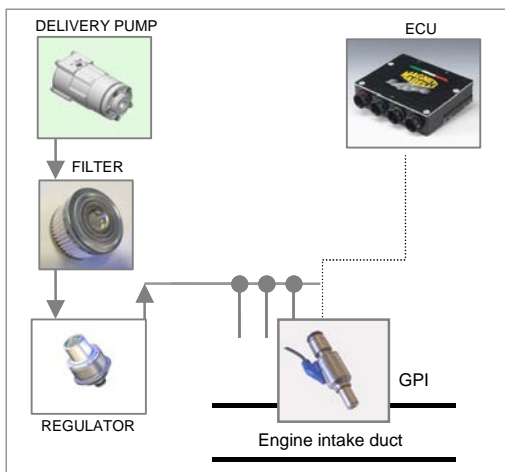

Dimensions

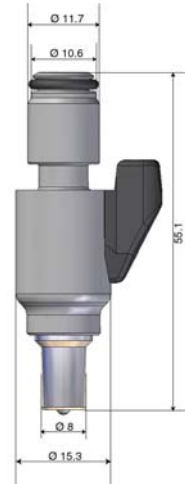

Dimensions in millimetres

GPI Family

For more information regarding the spray angle, please contact us.

Injector	GPI 001	GPI 002	GPI 003	GPI 004	GPI 011	GPI 017	GPI 018	GPI 019	
Nominal pressure	1	1	1	1	1	1	0.3	0.5	MPa
Static flow rate	1158	740	1158	1053	1061	719	149	60	cm ³ /min
Spray shape	Circular cone	Circular cone	Circular cone	Twin jet	Circular cone	Twin jet	Cone	Cone	

For further information, please contact:



Magneti Marelli S.p.A.
Motorsport
Viale Aldo Borletti, 61/63
20011 Corbetta (Milano) Italy

Tel. +39 02 972 27 478
Fax +39 02 972 27 570
sales@magnetimarelli.com
http://www.magnetimarelli.com

November 2010
rel. 10
page 2 of 2

GPI-0838XXXXXX00